

---

OPERATION AND MAINTENANCE  
INSTRUCTIONS FOR THE

**WILCOX<sup>®</sup>**

**G22<sup>™</sup>**

**Low Profile Non-Breakaway Mount**

**PN: 28300G22**

***“The Most Trusted Helmet Mount in the World”***

**Mount Up!<sup>®</sup>**

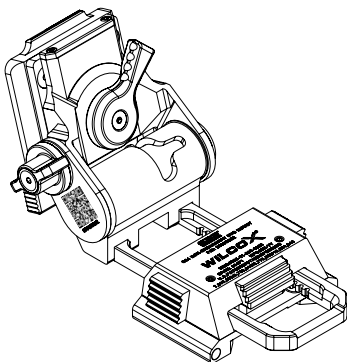

**CAGE: 004F1**

**EAR99 NLR: No Export License Required.**

---

## **CONFIGURATION**

### **ATTACH/DETACH NVG MOUNT - ATTACH/DETACH THE NVG MOUNT**

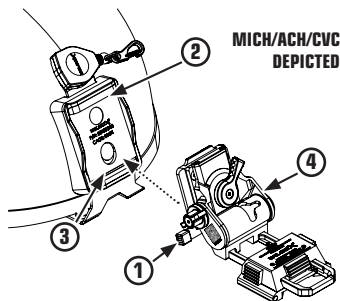

### **ATTACH THE NVG MOUNT**

- 1.)** Push the Mount Release Lever **(1)** in to unlock the release mechanism.
- 2.)** Insert the Mount on an angle into the interface receiver **(2)**, then pivot the Mount into the pocket **(3)**.
- 3.)** Push the Mount Release Lever **(4)** in to lock the release mechanism.
- 4.)** Push the Mount down firmly at the base to seat, allowing the Mount to achieve its position.

---

## **ATTACH/DETACH NVG MOUNT - ATTACH/DETACH THE NVG MOUNT (CONTINUED)**

### **DETACH THE NVG MOUNT**

- 1.)** Push the Mount Release Lever **(1)** in to unlock the release mechanism.
- 2.)** Remove the Mount.

---

## **ATTACH NVG - ATTACH AN NVG TO THE MOUNT**

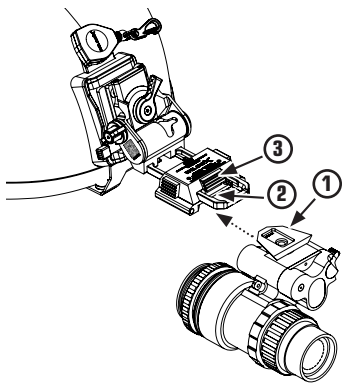

### **ATTACH AN NVG**

Insert the dovetail shoe **(1)** into the dovetail interface of the NVG Mount **(2)**. Push in until it clicks.

Gently pull to make sure the NVG is secure.

### **DETACH AN NVG**

Hold the NVG, push the NVG Release Button **(3)**, then pull out the NVG.

---

## **OPERATION**

### **PIVOT - STOWING/DEPLOYING THE NVG**

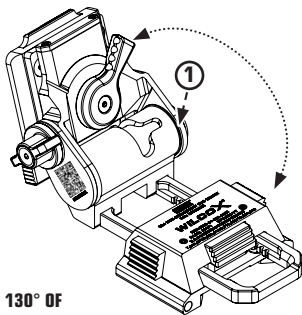

**130° OF  
ROTATIONAL  
TRAVEL**

Push the Flip Release Button **(1)**, then pivot the Mount to the stowed or deployed position and release the Button.

### **UP/DOWN - ADJUSTMENT OF THE NVG**

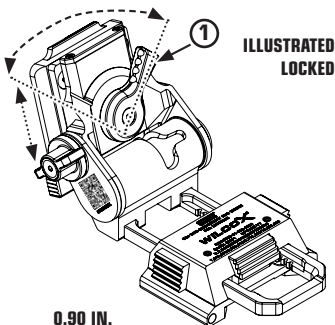

**ILLUSTRATED  
LOCKED**

**0.90 IN.  
VERTICAL  
TRAVEL**

Turn the Lever **(1)** CCW to unlock. Adjust the Mount height. Turn the Lever CW to lock.

---

## **FORE/AFT - ADJUSTMENT OF THE NVG**

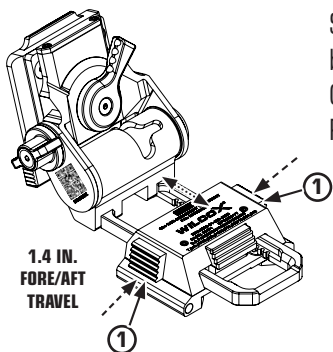

Simultaneously push both buttons **(1)** in to move the Carriage forward or backward. Release the buttons to lock.

## **TILT - ADJUSTMENT OF THE NVG**

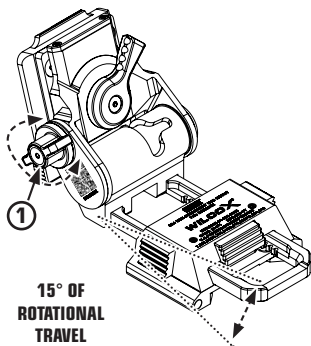

Turn the tilt angle adjustment knob **(1)** CW to raise the angle or CCW to lower the angle.

---

## CARE AND MAINTENANCE

Clean the mount by flushing away dirt with fresh water and/or wiping down the assemblies with a clean, damp cloth. If used in a saltwater environment, flushing with fresh water and drying after use is recommended. If used extensively in a saltwater environment, lightly lubricate stainless steel parts as needed. Vertical and horizontal adjustment and release mechanisms that are not kept free from debris may bind and the assembly may not lock the mount in the up or down position. Lubricate lightly as needed. Check the Tilt Adjustment and NVG Interface for any play in the mechanisms. If necessary, tighten the screws with a hex driver.

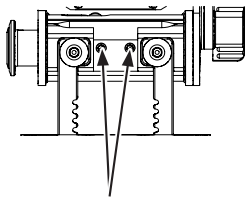

INSERT 1/16 HEX DRIVER TO  
ADJUST. TURN CCW TO LOOSEN,  
CW TO TIGHTEN.

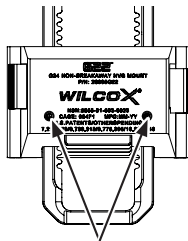

INSERT .050 HEX DRIVER TO  
ADJUST. TURN CCW TO LOOSEN,  
CW TO TIGHTEN.

***Tightening Tilt Adjustment Screws***

***Tightening NVG Interface Screws***

Wilcox prides itself in providing the operator with the most trusted mount in the world. To accomplish this, it is essential to understand the science behind our mounting solution. Without a stable mounting system, an adverse condition can develop that compromises the reason for its existence. Wilcox has engineered the helmet Shroud, Mount, and NVG Shoe to work as one system. Any off-brand shrouds could affect the rigidity, thereby affecting the stability of the goggle. An extensive amount of effort is put into this, and Wilcox cannot honor a warranty claim if an off-brand shroud is used with our mount.

---

## **GENERAL SAFETY WARNINGS**

### **▲ WARNING ▲**

**When attaching a Night Vision Goggle (NVG) to the G22, Wilcox recommends a positive lock at the top of the throw. Personal injury could result from an inadvertent “flip-down” of the mount with an NVG attached.**

---

### **NOTE**

---

**When using an NVG with the G22, NVG Interface Shoes made of aluminum are highly recommended for the NVG to increase ruggedness of the overall system interface. If the NVG has plastic dovetails, these can be easily changed to the aluminum dovetail interface shoes with the use of a hex key, as they are held on by a button head hex screw (contact Wilcox for part ordering information).**

**The NVG may be worn further away from the eyes to accommodate corrective or protective eyewear, goggles, and protective masks.**



---

## **WARRANTY CLAIM AND SERVICE INFORMATION**

For warranty claim or service work, WX must be contacted in the United States at (603) 431-1331 or Customer Service through our online support page at [wilcoxind.com/contact](http://wilcoxind.com/contact) to obtain a **Return Merchandise Authorization (RMA)/Service Call Number (SC)** prior to returning your Wilcox product.

After an RMA/SC number is issued, WX will accept your package at the address indicated below, clearly marked with the RMA/SC number:

**Wilcox Industries Corp.**  
**RMA/SC # \_\_\_\_\_**  
**One Wilcox Way**  
**Newington, NH 03801 USA**

The Wilcox product must be securely packaged to prevent damage, accompanied by your name, address, daytime phone number to contact you, and a description of the problem or work you wish to be performed.

**Manufactured by:**

**WILCOX<sup>®</sup>**

**Wilcox Industries Corp.  
One Wilcox Way  
Newington, NH 03801 USA**

**Phone: +1 603-431-1331**

**Fax: +1 603-431-1221**



**WWW.WILCOXIND.COM**

**For troubleshooting service questions,  
contact Wilcox between 8am and 5pm EST.**

© 2009-2024 Wilcox Industries Corp. All rights reserved. Printed in USA. US Patents 9,625,699 and 10,004,289. Wilcox<sup>®</sup>, the Wilcox "X" logo, and "Mount Up!<sup>®</sup>" are federally registered trademarks of Wilcox Industries Corp. All other trademarks and registered trademarks in this manual are the property of their respective companies. Specifications and other data are subject to change without notice.